

---

## Ground Floor

Kitchen/Breakfast

21.67 m<sup>2</sup>

Dining

7.83 m<sup>2</sup>

Utility

3.42 m<sup>2</sup>

Lounge

15.03 m<sup>2</sup>

Hall

9.72 m<sup>2</sup>

---

Plot No. 7

3 Bedroom home  
with single garage and parking

Plot No. 8

3 Bedroom home  
with double car port

Plot No. 9

(detail as Plot No. 7 mirrored)

3 Bedroom home  
with private drive and ample parking

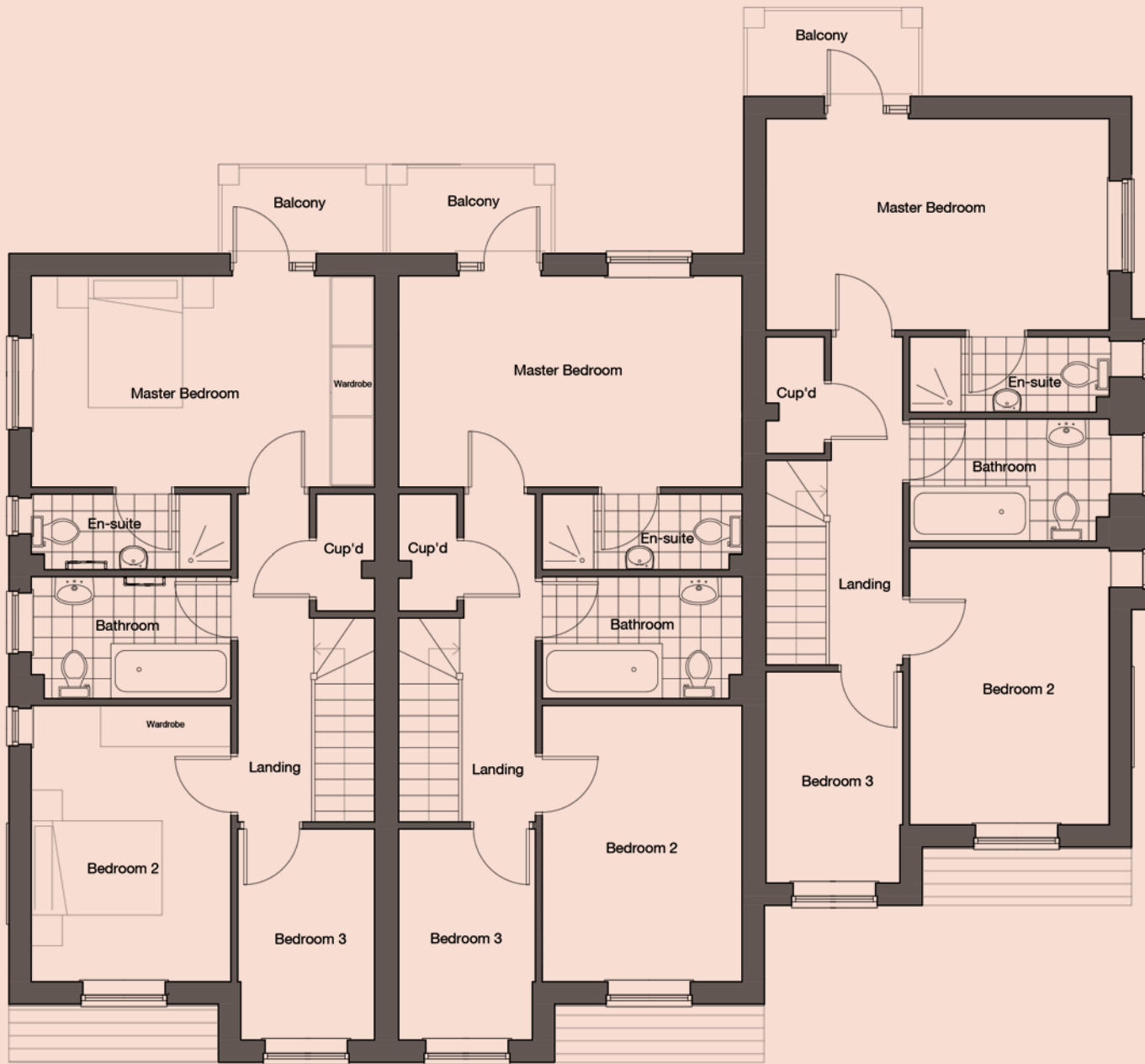

Plot No. 7

Plot No. 8

Plot No. 9  
(detail as Plot No. 7 mirrored)

---

## First Floor

Master Bedroom  
15.6 m<sup>2</sup>

En suite  
3.56 m<sup>2</sup>

Bed 2  
11.82 m<sup>2</sup>

Bed 3  
5.84 m<sup>2</sup>

Bathroom  
5.78 m<sup>2</sup>

---